

Gasperich, Route d'Esch

# office center *avant projet*

ATELIER D'ARCHITECTURE  
DARIUSZ PAWLWOSKI sarl

PRO  
group

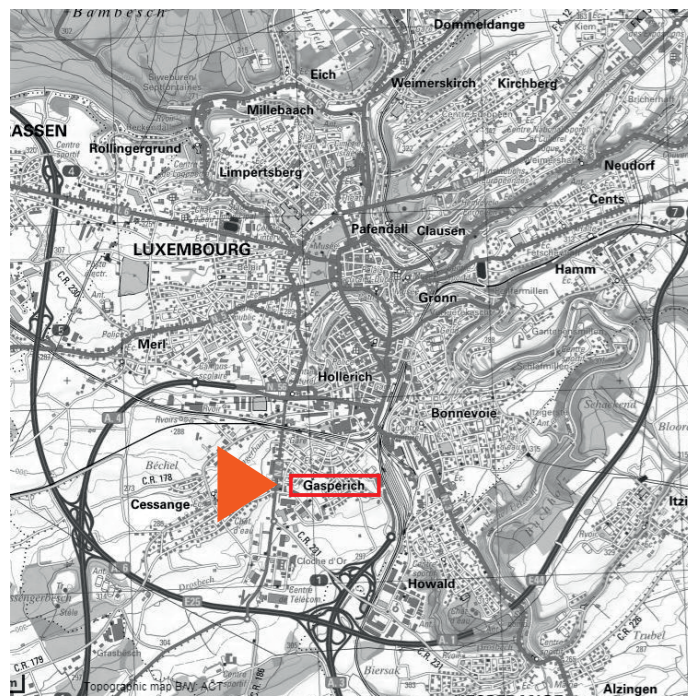

# office center

avant projet



## SITUATION

SURF. BATIE: 303m<sup>2</sup>  
 SURF. BRUT. TOTAL: 2017m<sup>2</sup>  
  
 S. NET. APP. TOTAL: 1030m<sup>2</sup>  
 SURF. NET.TOTAL: 1595m<sup>2</sup>  
  
 VOLUME HORS-SOL: 6089m<sup>3</sup>  
 VOLUME TOTAL: 6937m<sup>3</sup>  
  
 PARKING: 12 empl.

 SURFACE PROPRIETE NOUVEAU: 502,9m<sup>2</sup>  
 CESSION OBLIGATOIRE: 59,1m<sup>2</sup>  
 } 562m<sup>2</sup>

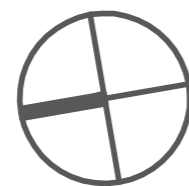

alignement selon  
construction 90/2510

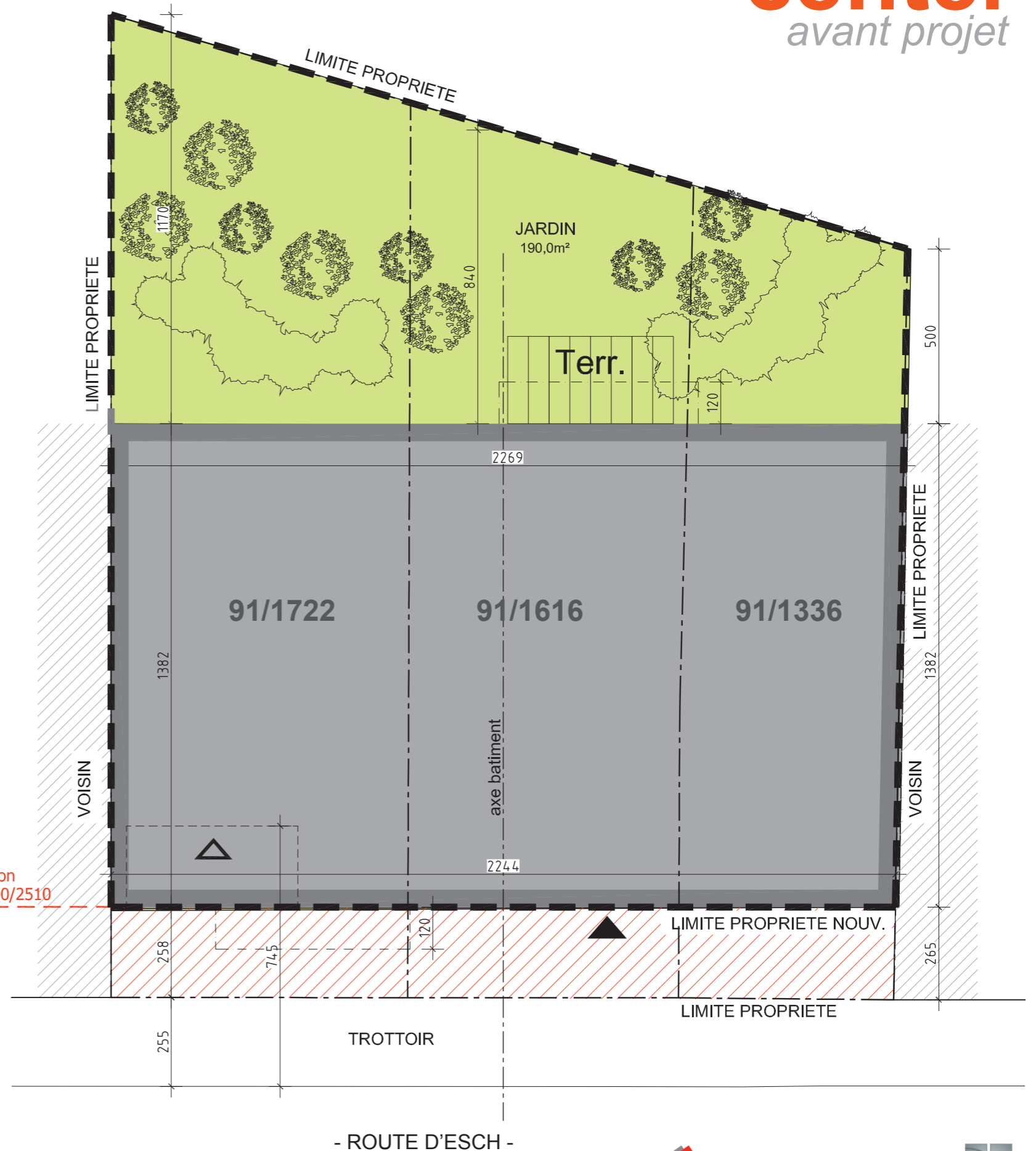

# IMPLANTATION

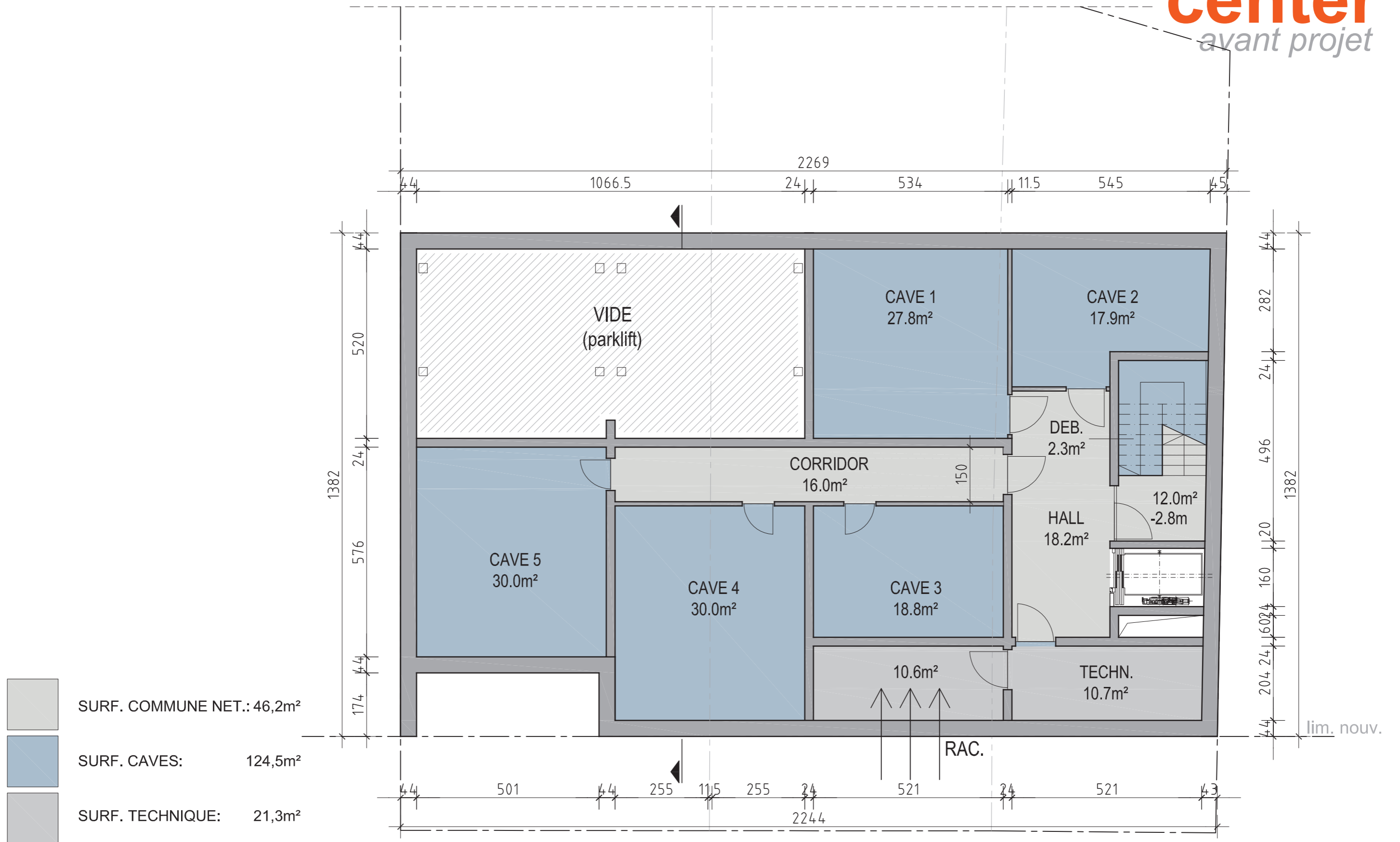

### SOUS-SOL ver. 1 (bureaux)

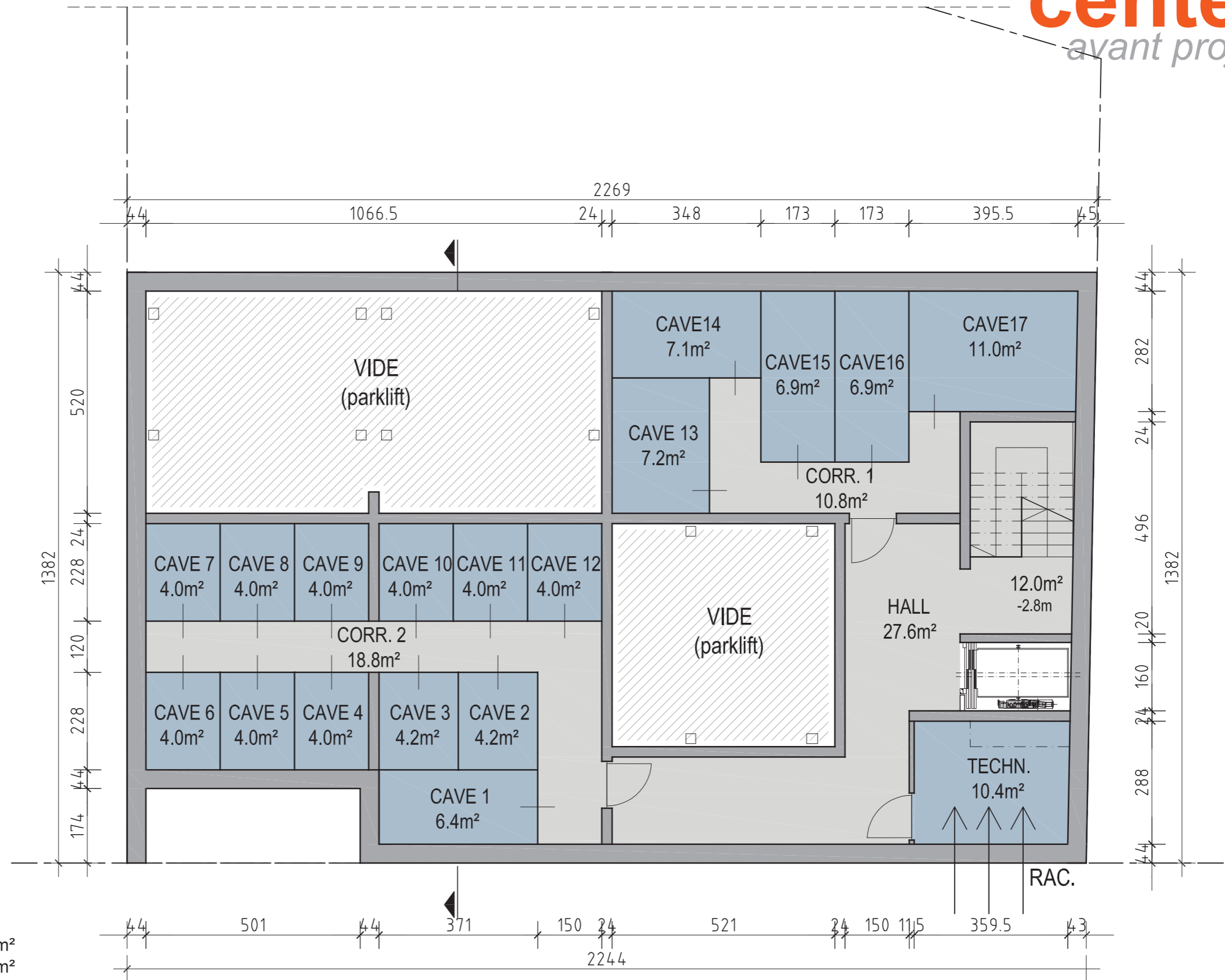

SURF. BRUT.: 303,0m<sup>2</sup>  
SURF. SOUS-SOL NET.: 169,5m<sup>2</sup>

## SOUS-SOL ver. 2 (appartements)

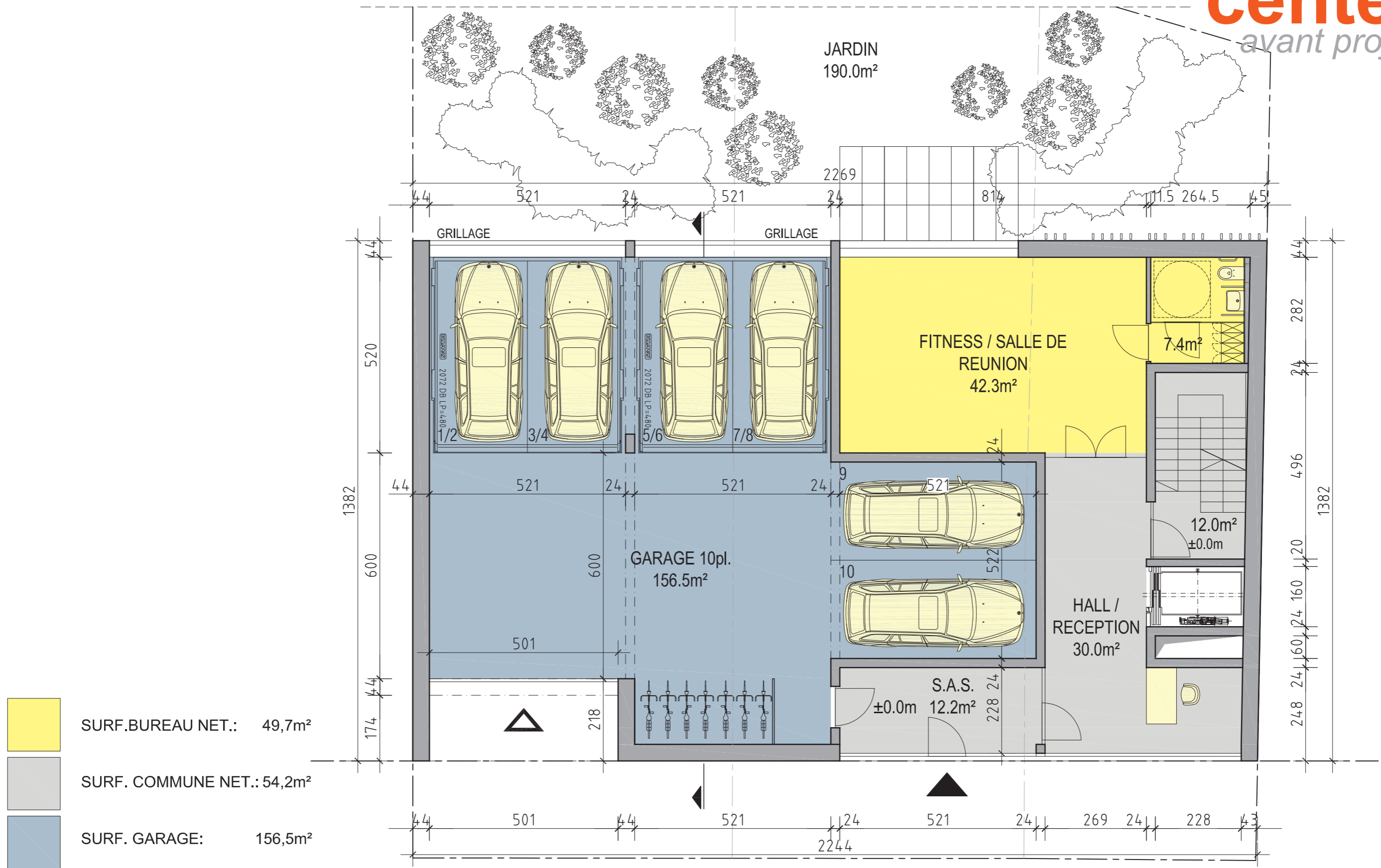

# REZ-DE-CHAUSSEE ver. 1 (bureaux)



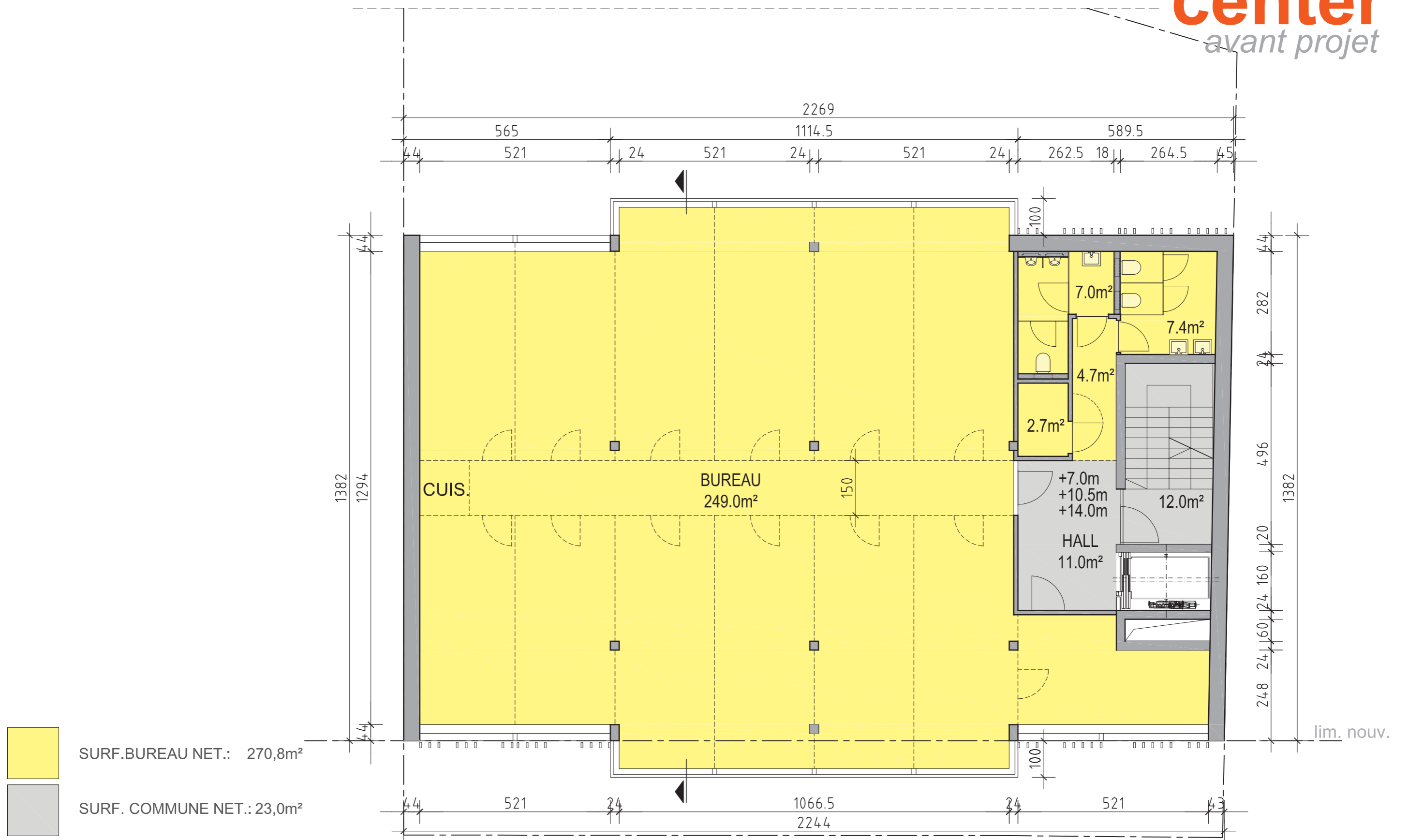

### ETAGES +2,+3,+4 ver. 1 (bureaux)



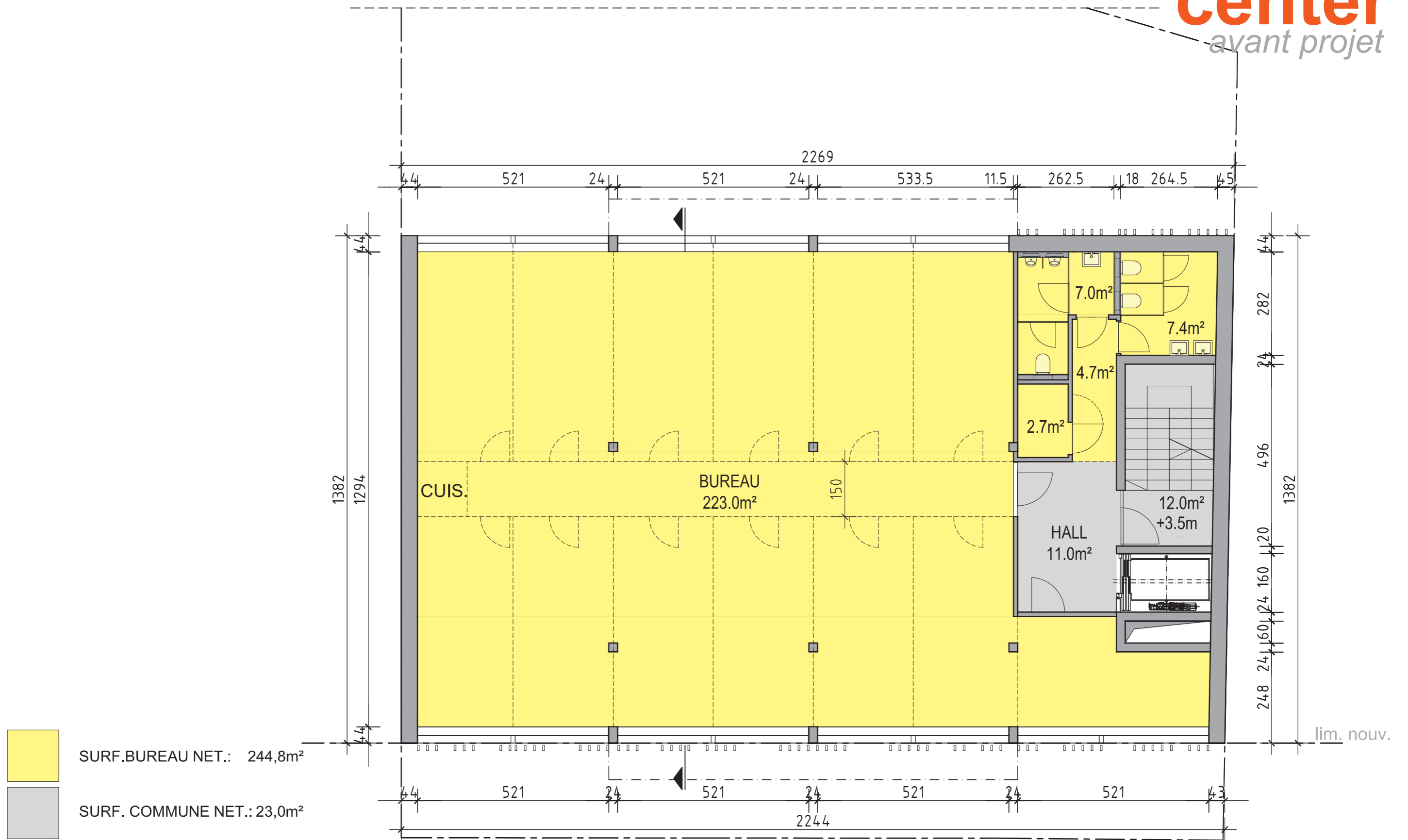

### ETAGE +1 ver. 1 (bureaux)

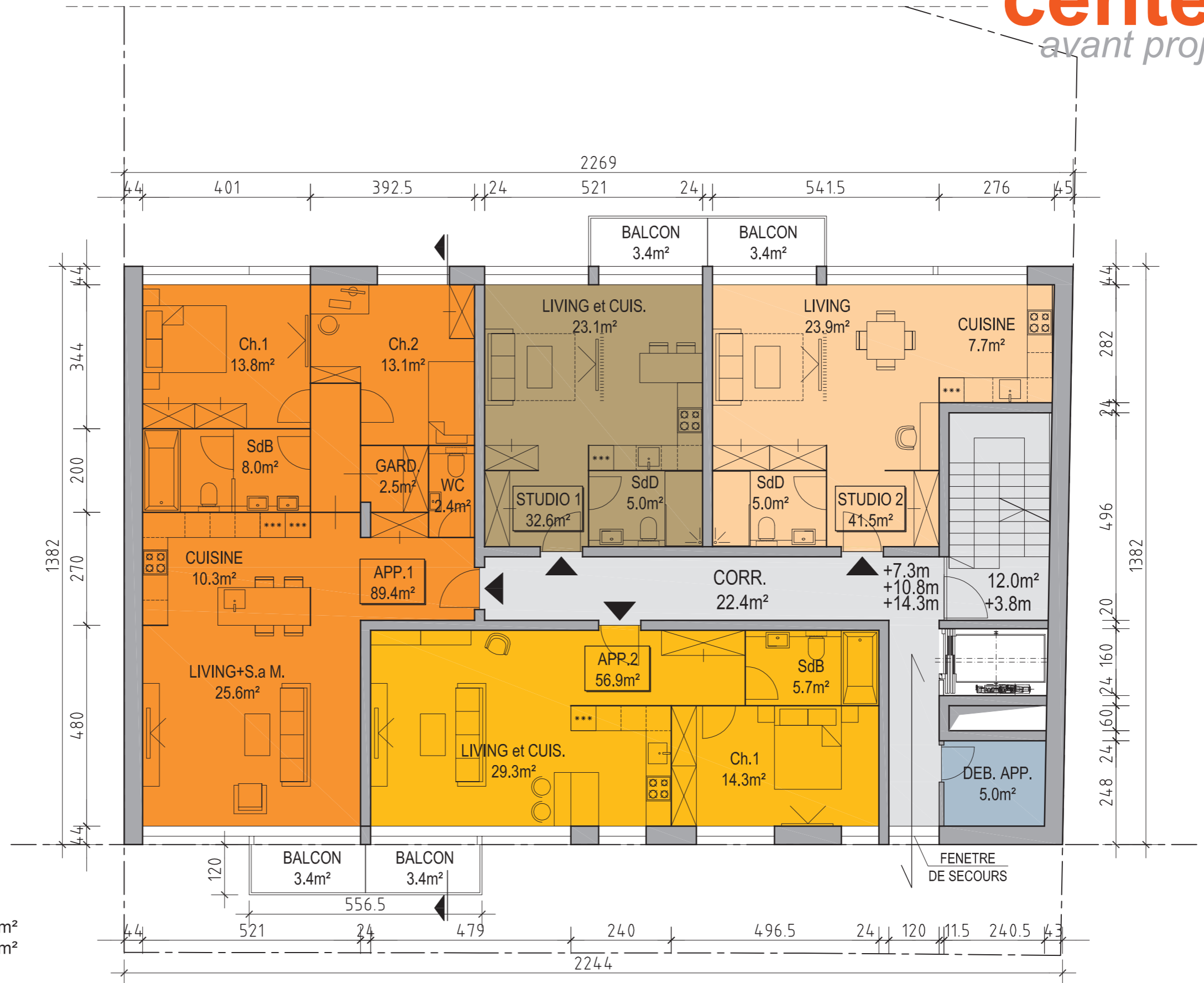

SURF. BRUT.: 311,9m<sup>2</sup>  
SURF. ETAGE NET.: 259,8m<sup>2</sup>

**ETAGES +1, 2,+3,+4 ver. 2 (appartements)**

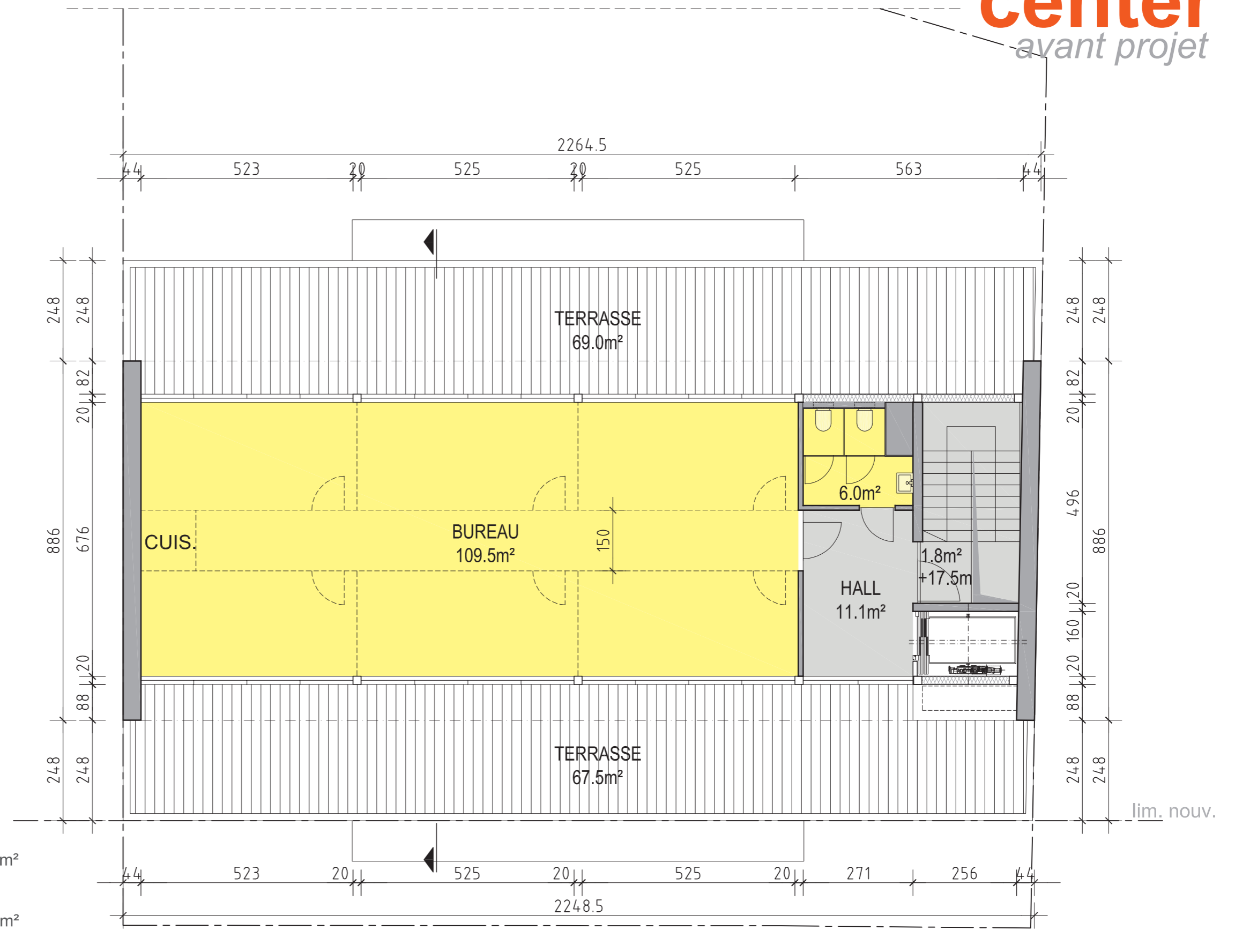

# ETAGE +5 RETRAIT (bureaux)

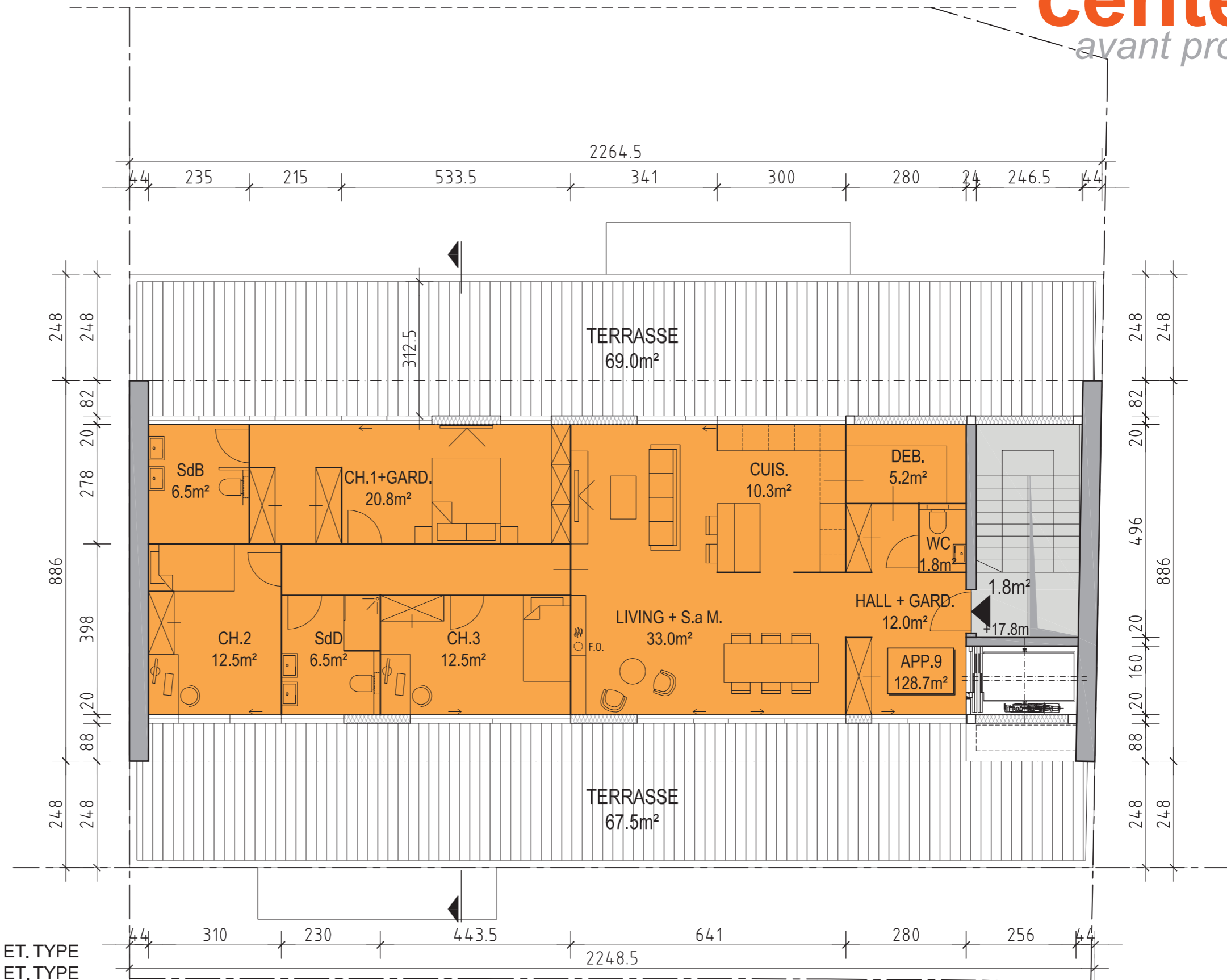

SURF. BRUT.: 163,0m² << 80% ET. TYPE  
 SURF. ETAGE NET.: 130,5m² << 80% ET. TYPE

## ETAGE +5 RETRAIT (appartements)



# office center

avant projet



VISUALISATIONS

